

AGES AND STAGES - GENERAL GUIDELINES

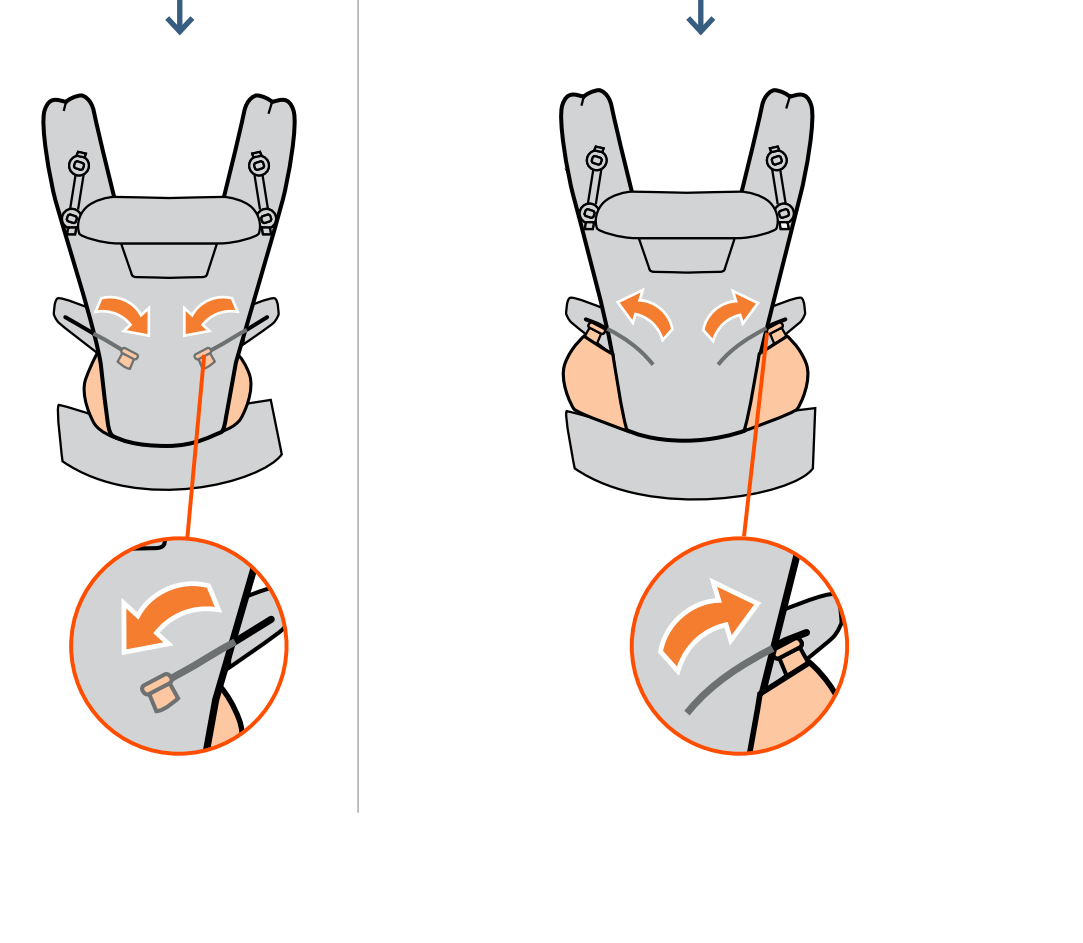

2 BABY POSITIONING CHECKLIST & TIPS

2A Baby close enough to kiss, high on your body

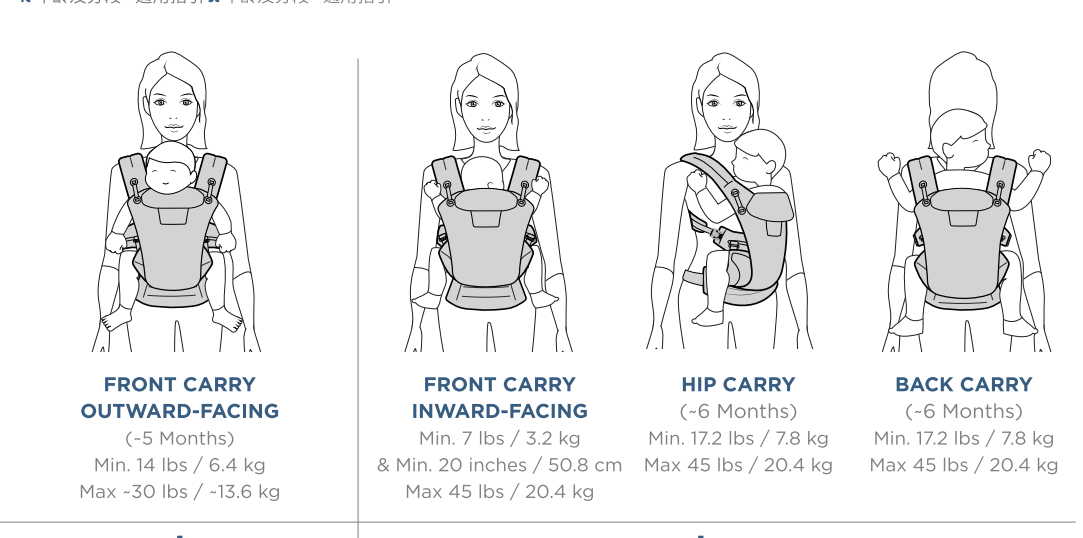
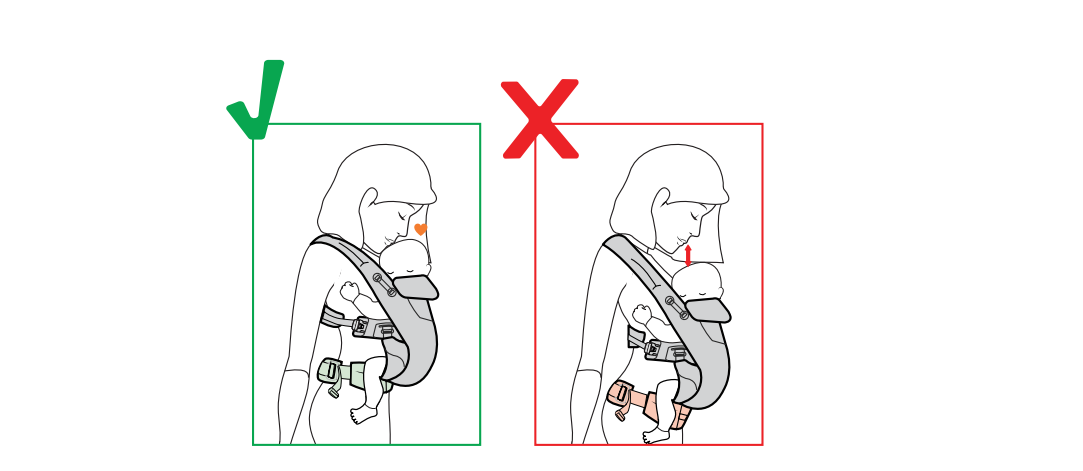

2B Deep seat with knees high

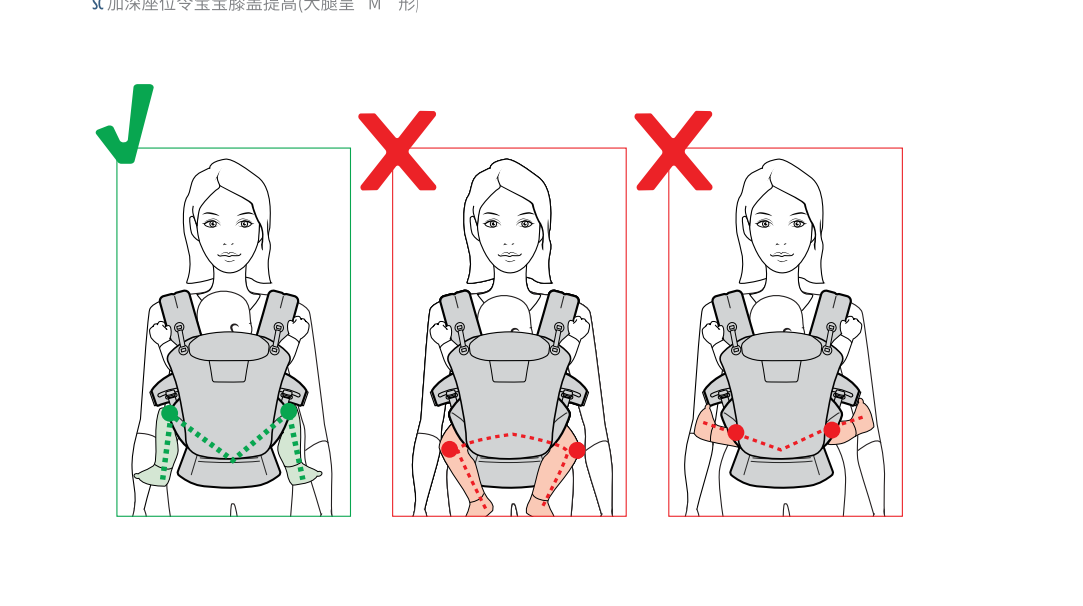

5 FRONT CARRY INWARD-FACING WITH PARALLEL "H" STRAPS

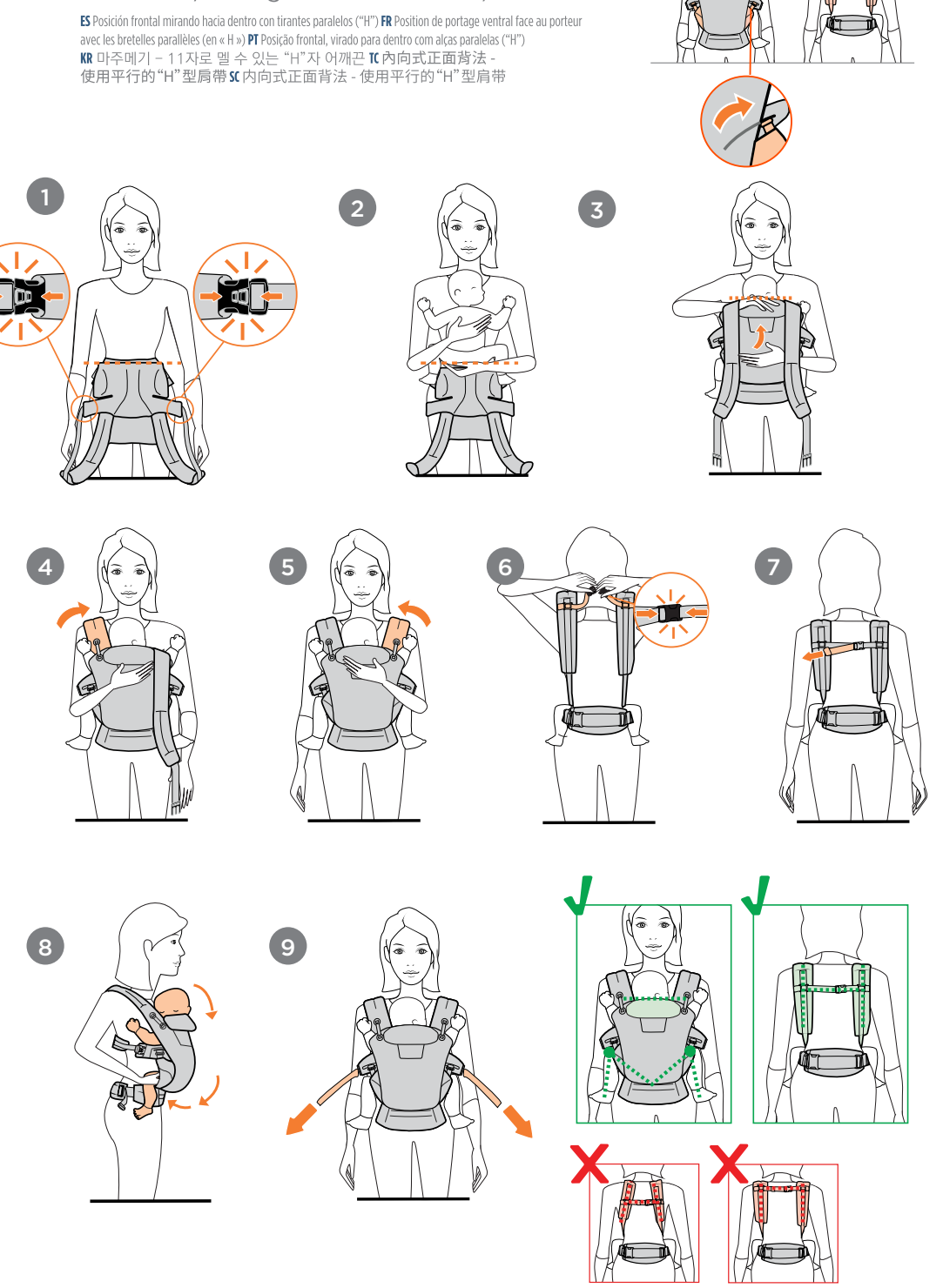

1 FOLLOW THESE EASY STEPS TO GET STARTED

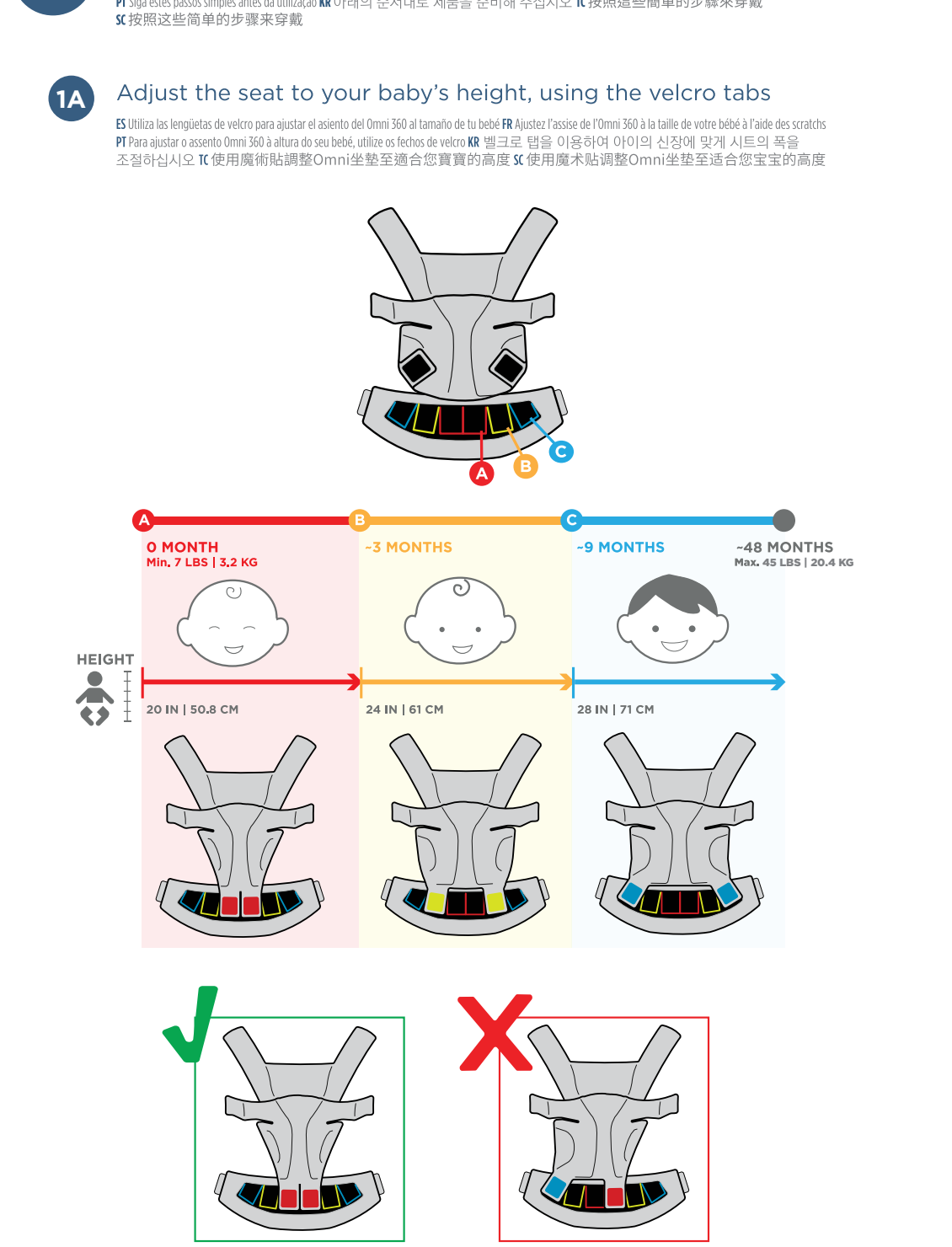

2C Spine in soft, rounded shape

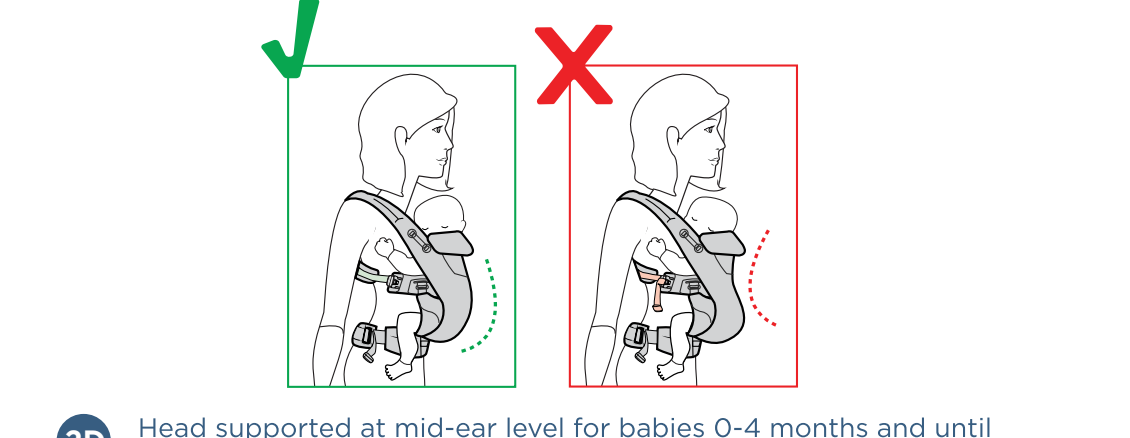

2D Head supported at mid-ear level for babies 0-4 months and until baby has strong head and neck control

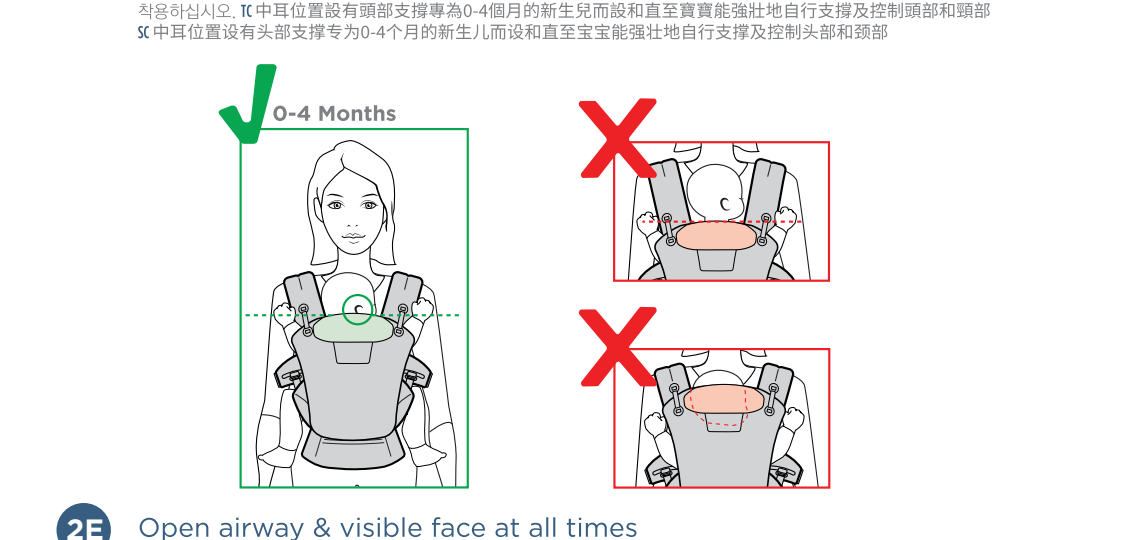

2E Open airway & visible face at all times

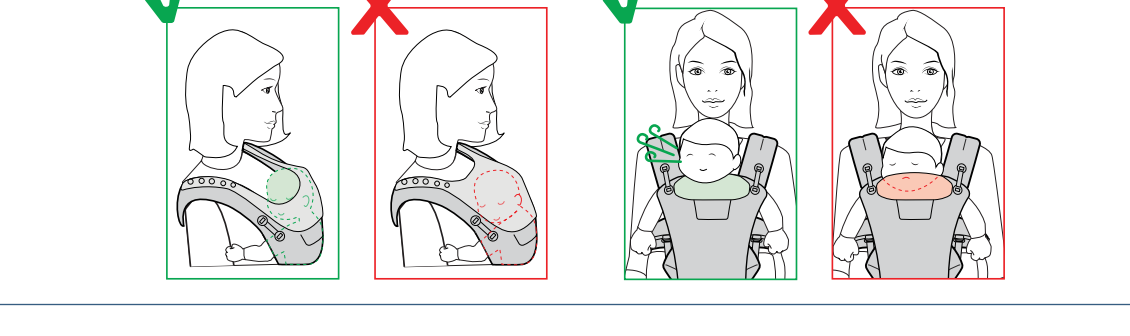

6 FRONT CARRY OUTWARD-FACING WITH CRISSCROSS "X" STRAPS

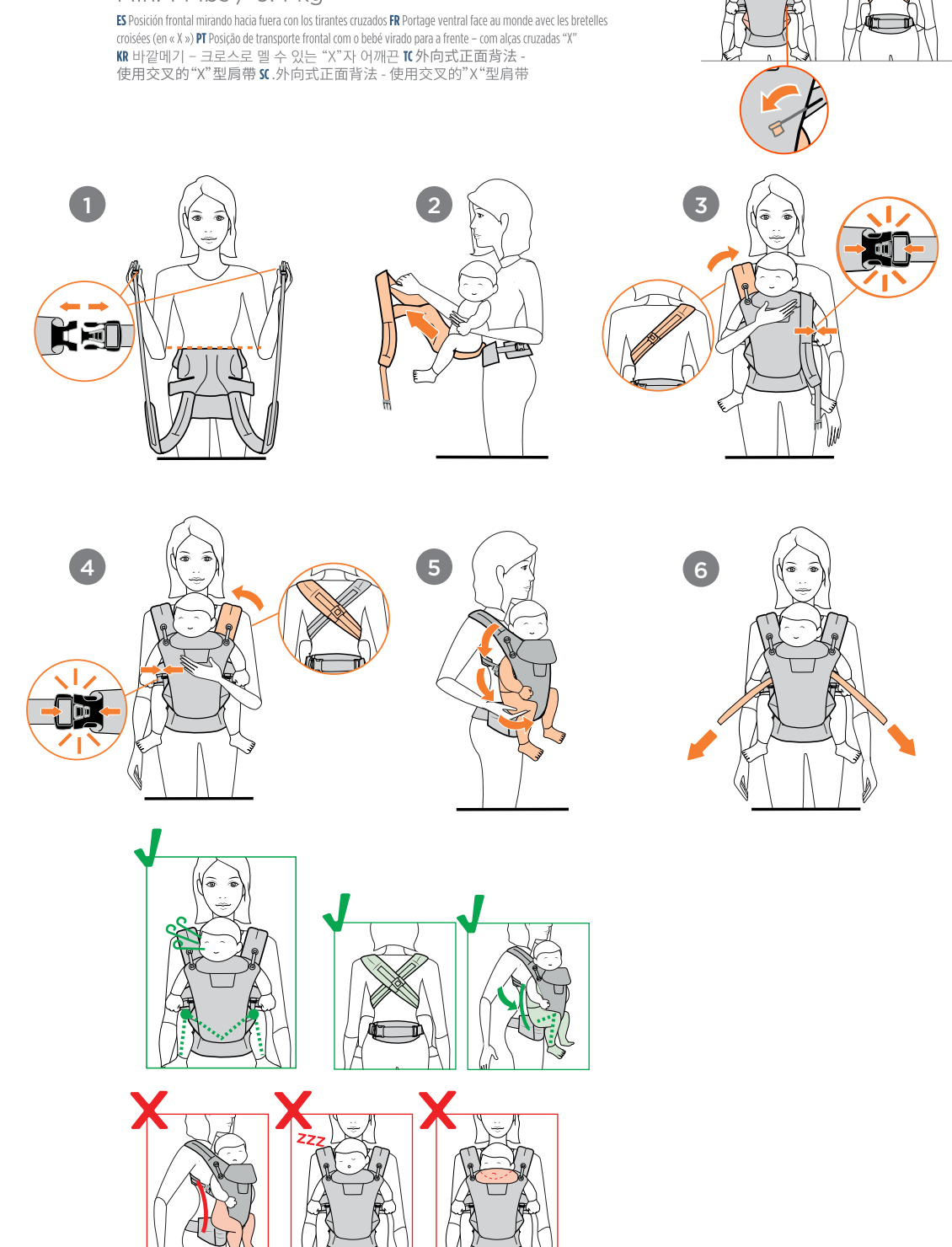

1B Position the head and neck support according to baby's age and activity

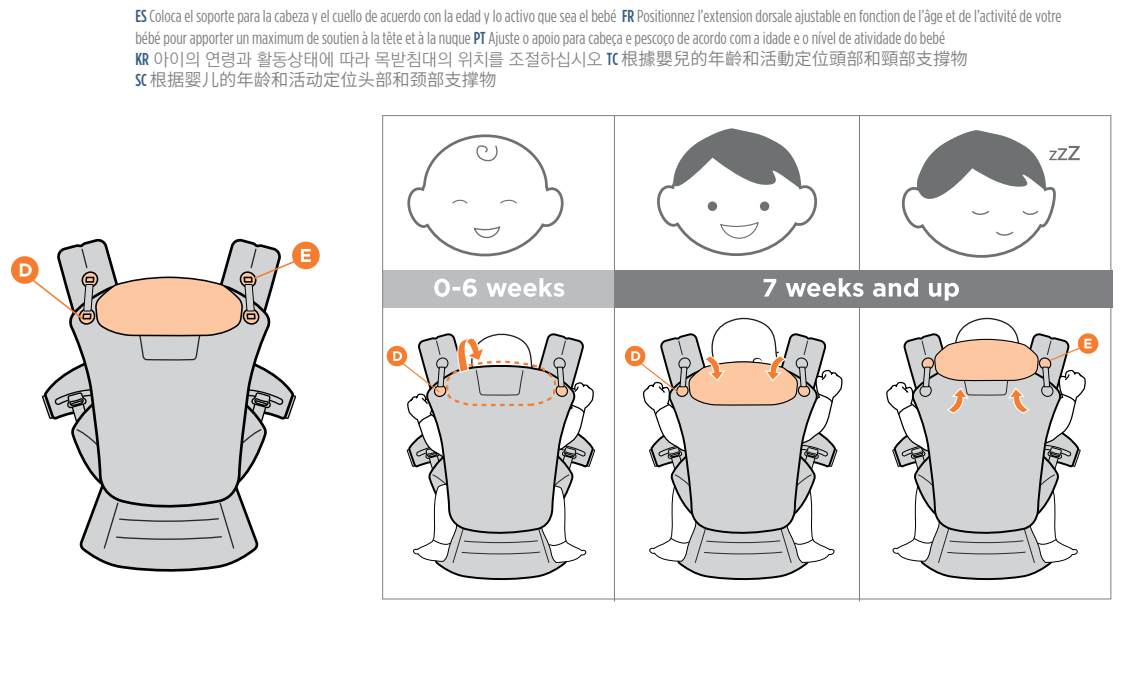

1C Adjust the carrier seat to face baby in or out, using the sliders

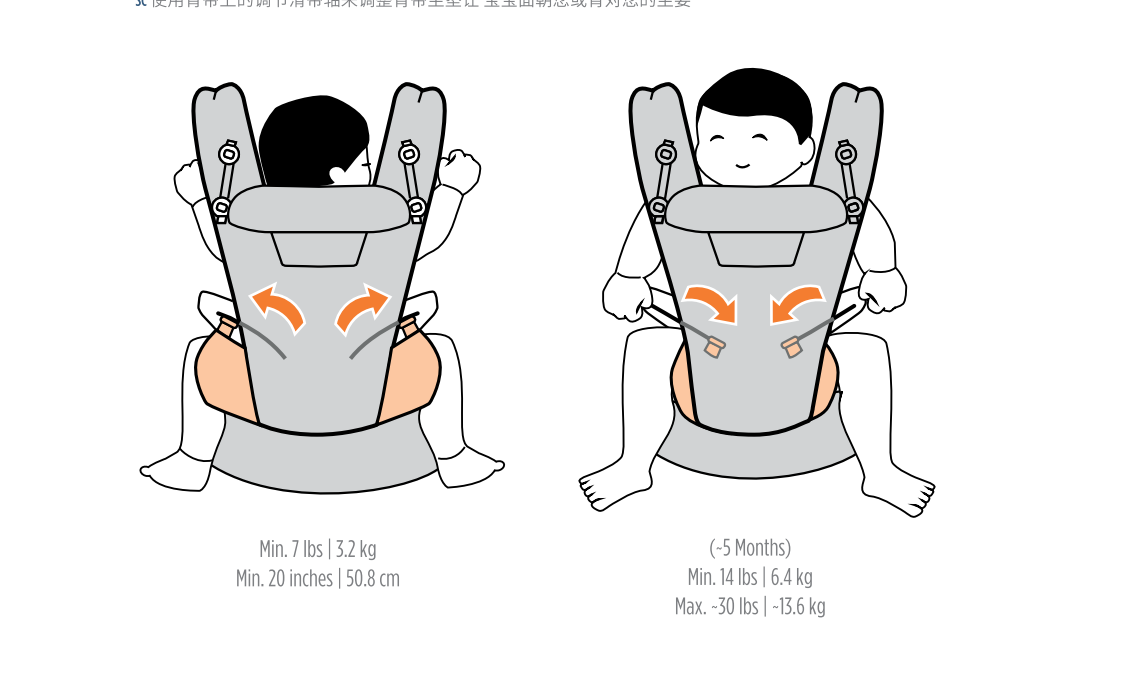

3 HOW TO ATTACH THE CARRIER WAISTBELT

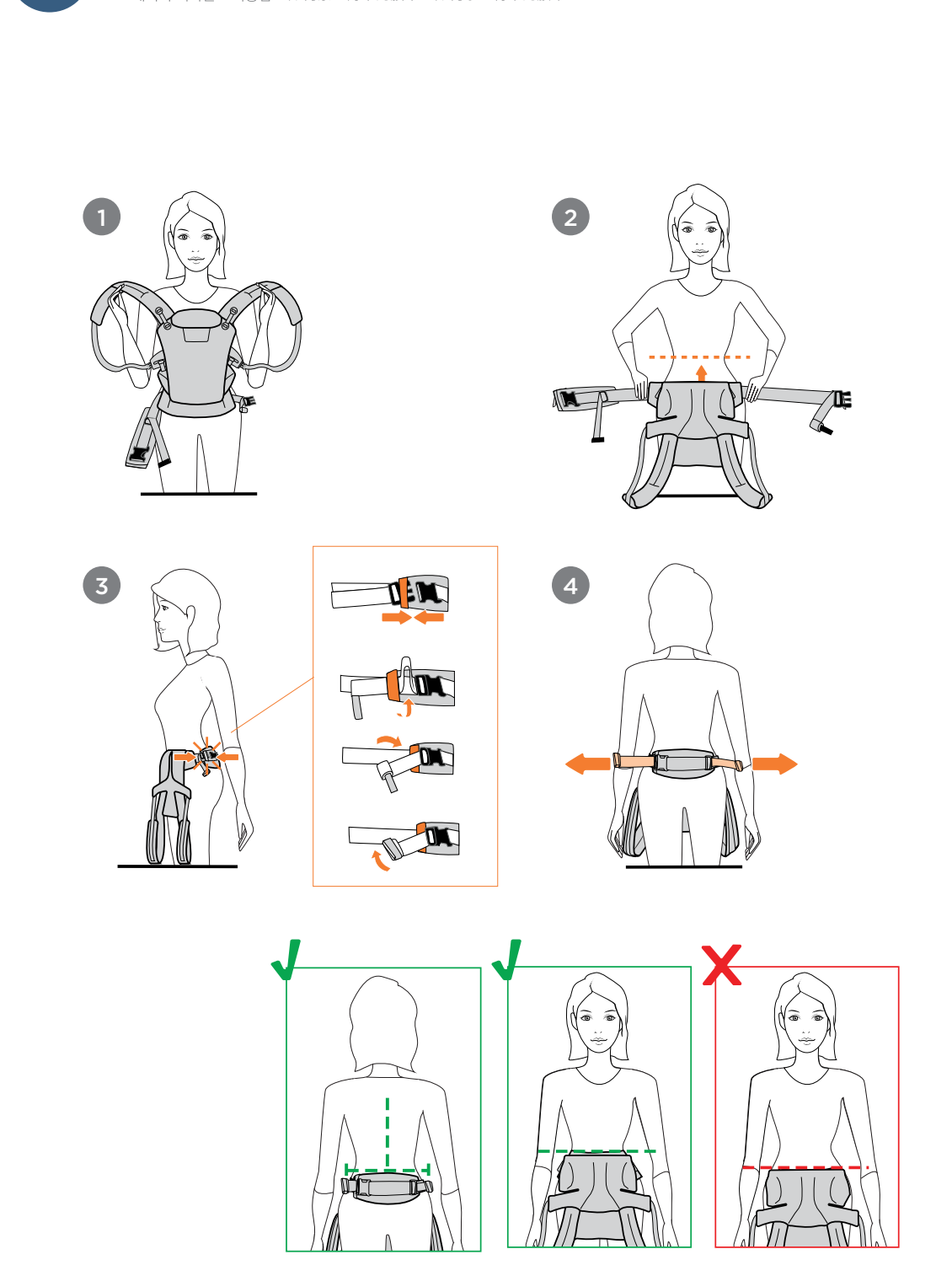

7 FRONT CARRY OUTWARD-FACING WITH PARALLEL "H" STRAPS

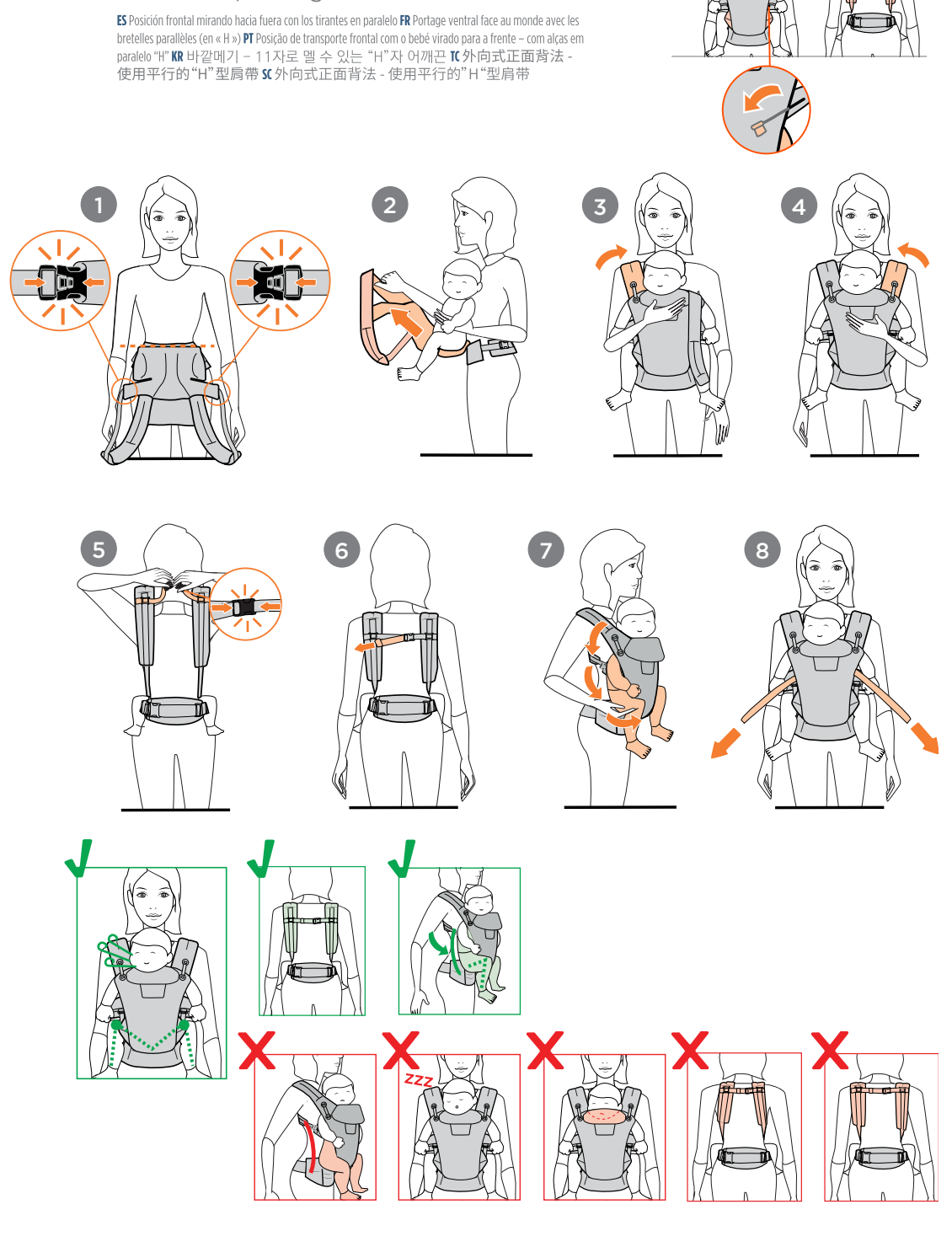

1D Loosen both shoulder straps



1E Push & Squeeze to unbuckle the shoulder straps if needed

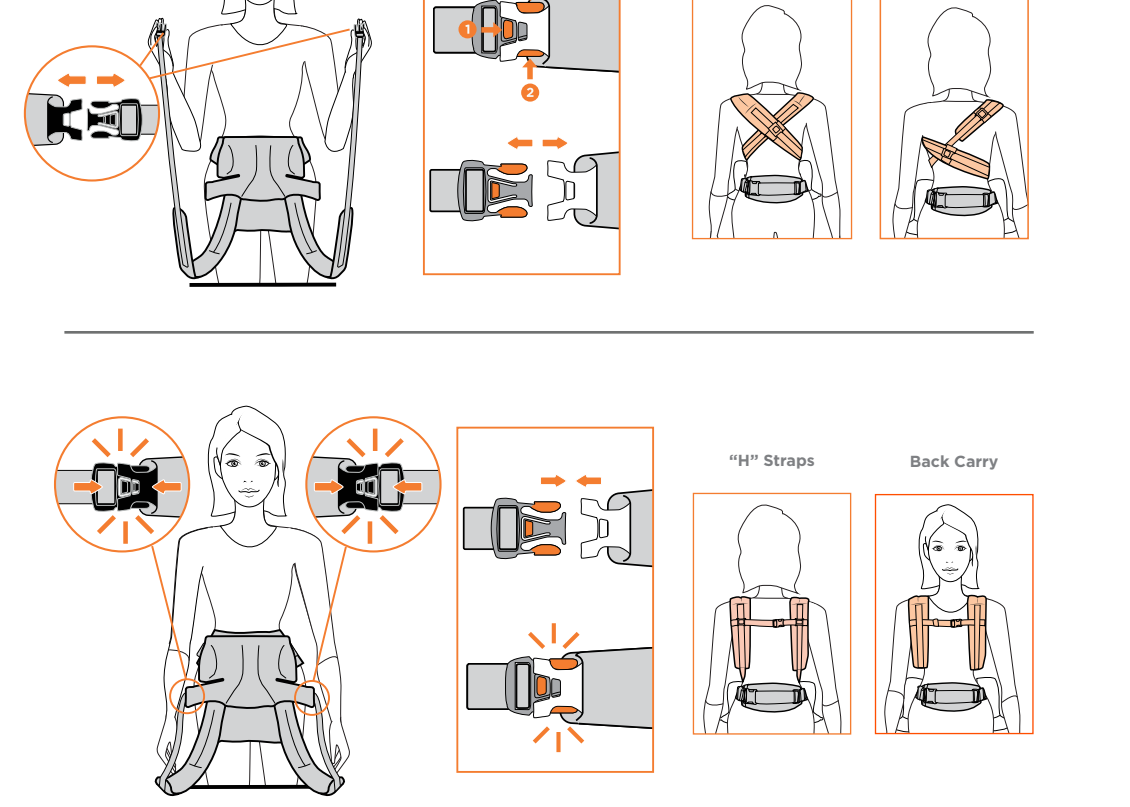

4 FRONT CARRY INWARD-FACING WITH CRISSCROSS "X" STRAPS

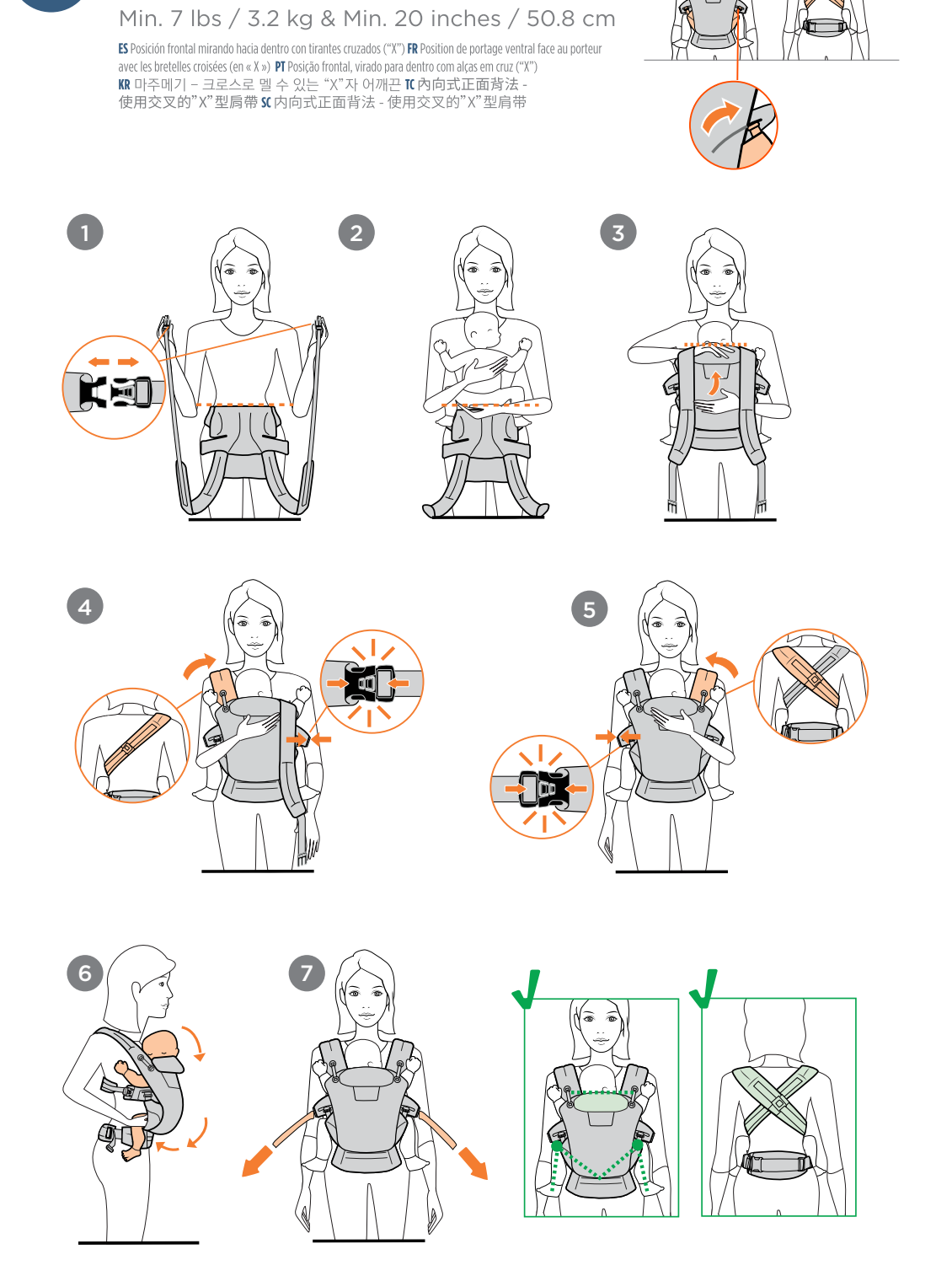

8 HIP CARRY

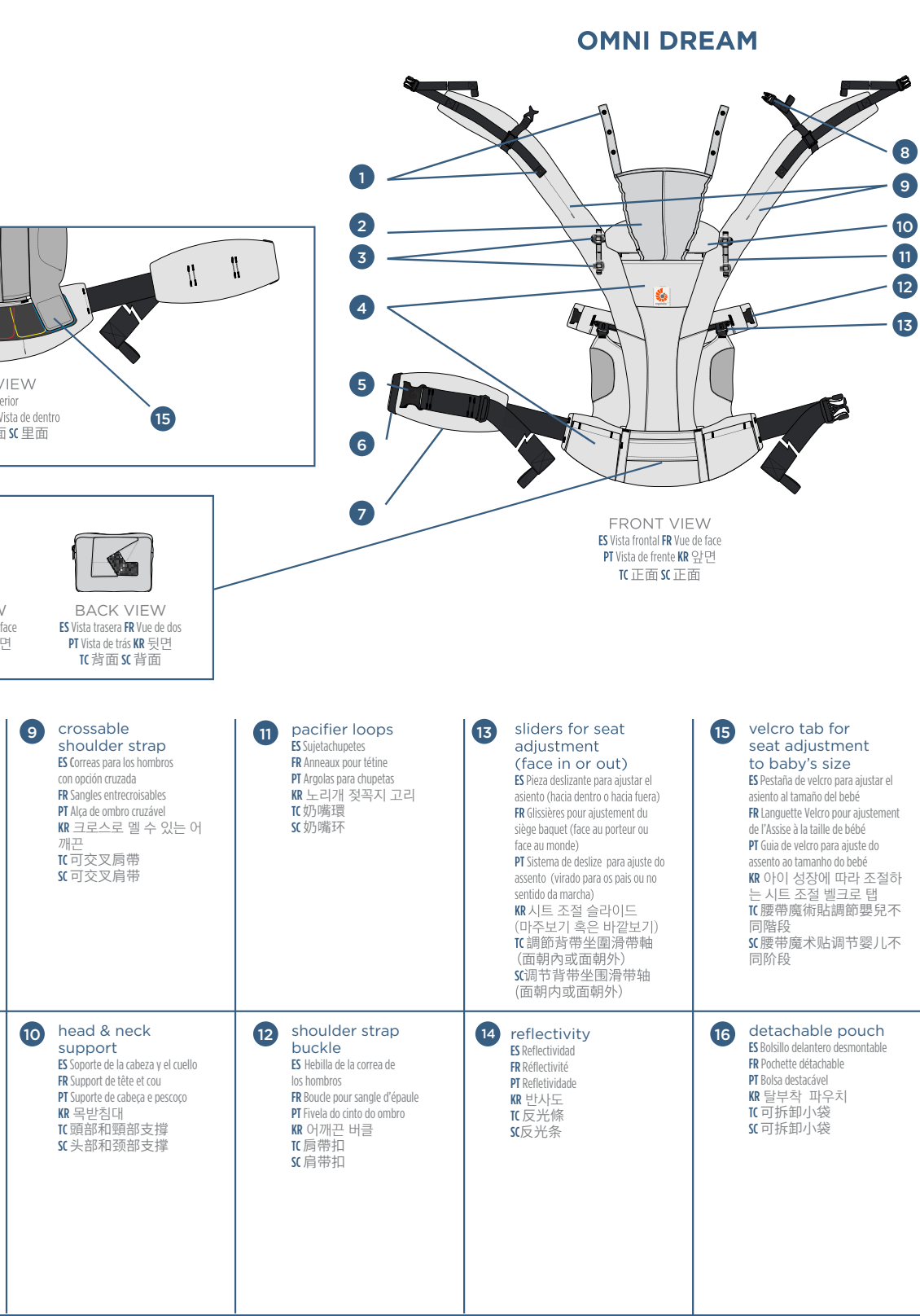
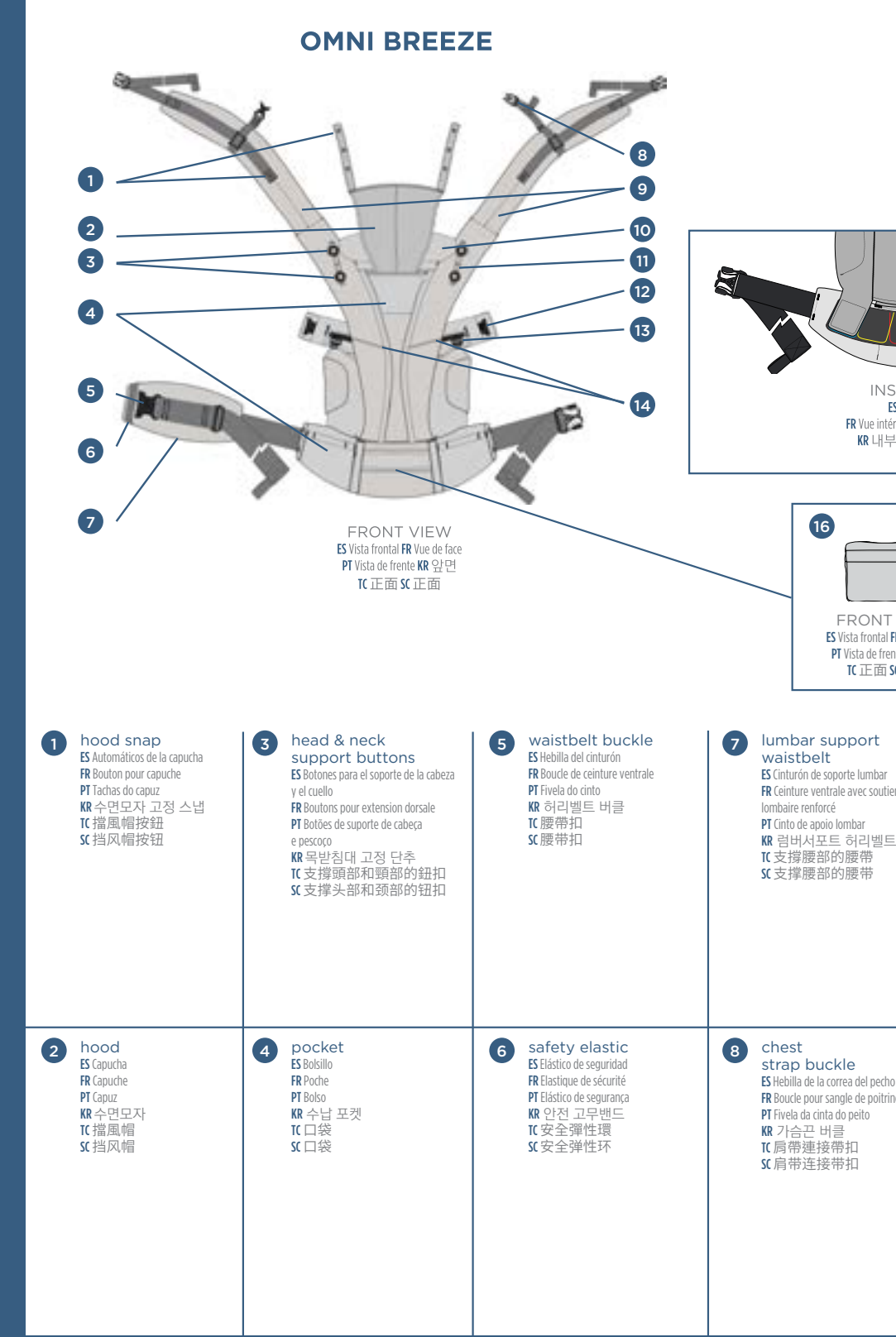
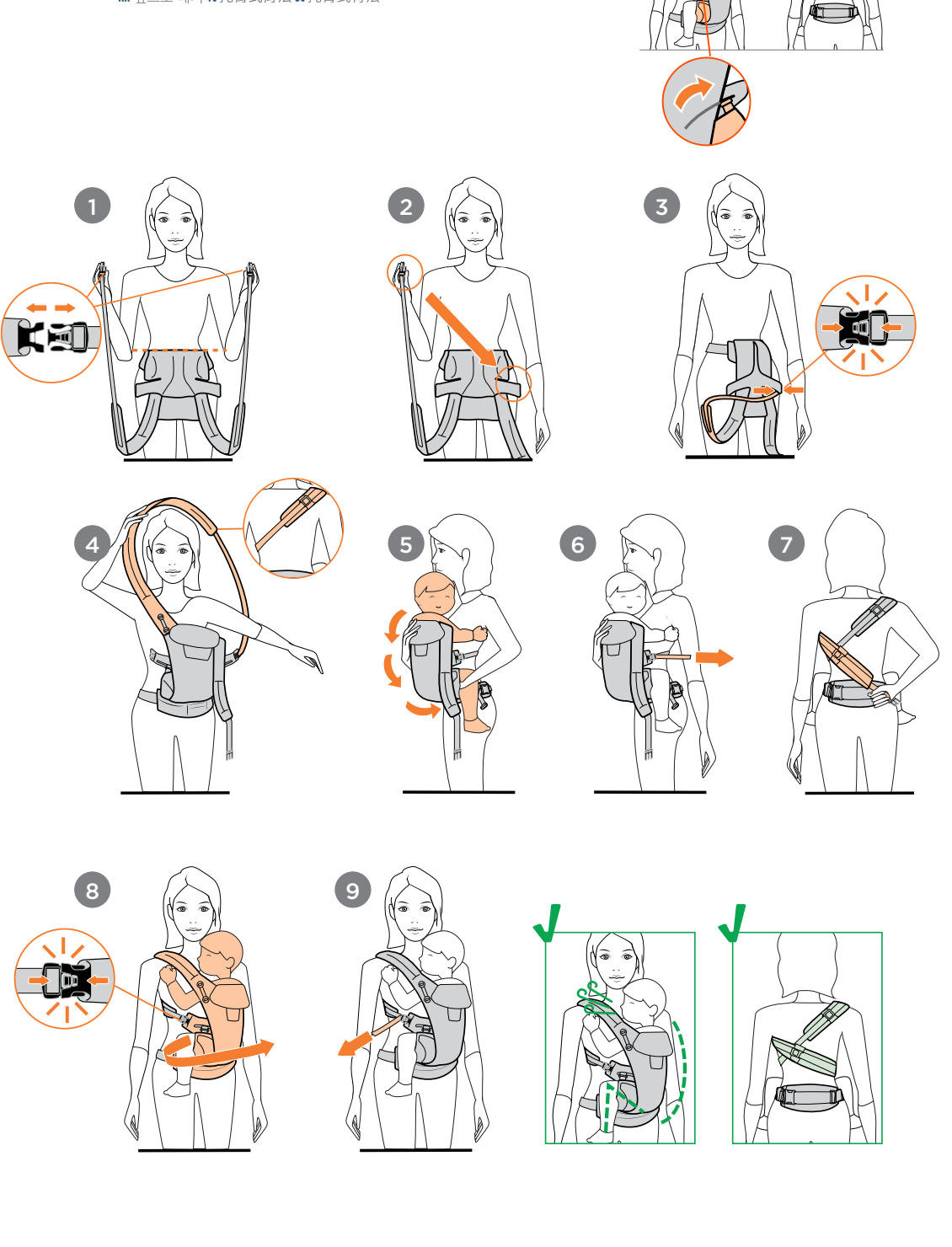

BABY CARRIER PARTS

1 hood snap	3 head & neck support buttons	5 waistbelt buckle	7 lumbar support	9 crossable shoulder strap	11 pacifier loops	13 sliders for seat adjustment	15 velcro tabs for seat adjustment
2 hood	4 pocket	6 safety elastic	8 chest strap buckle	10 head & neck support	12 shoulder strap buckle	14 reflectivity	16 detachable pouch

ergobaby

INSTRUCTION MANUAL

OMNI™ BREEZE & OMNI™ DREAM ALL-IN-ONE BABY CARRIER

Check out more tips and videos. Ergobaby.com

THE ERGO BABY CARRIER, INC. 1888 416 4888 | support@ergobaby.com

UK: EBP Lifestyle Brands UK Ltd. 01295 818888 | uk@ergobaby.com

DE: Mönchbergstraße 11, 20095 Hamburg, Germany +49 40 421 065 0 | customersupport@ergobaby.de

Pat: www.ergobaby.com/patents

RECYCLABLE

IM-OMNIBRZ+DRM_ROW_221212_V3

IMPORTANT! READ CAREFULLY AND KEEP FOR FUTURE REFERENCE

